



Philips Pocket Memo
dictation and
transcription set
with SpeechExec
workflow software

Digital
Slide-switch operation

POCKET MEMO

DPM7700

Voice to text made easy

with superior recording quality

The Philips dictation and transcription set allows you to turn voice into text even quicker than before. The Pocket memo digital voice recorder combines two microphones for superior audio quality with a robust yet lightweight ergonomic design. Together with the user-friendly software and convenient foot pedal, dictation and transcription has never been easier.

Professional recording solution

- Two microphones for superior stereo audio recordings
- High recording quality in DSS and MP3 format
- Wear-free ergonomic slide switch for efficient single-handed operation
- Robust stainless steel casing for extra durability
- Large color display and intuitive user interface for easy, convenient operation
- Power saving features and Li-ion battery for extended use
- Automatic file download via USB for quick transcription
- Classic mode for clear and easy-to-use operation

Professional transcription solution

- SpeechExec workflow software for easy data management
- Ergonomic foot pedal for convenient playback control
- Lightweight stereo headphones for enhanced wearing comfort
- Priority information for getting urgent jobs processed first

PHILIPS

Highlights

Superior audio quality



The built-in microphones deliver superior stereo audio recordings. The crystal clear recordings are perfectly suitable for speech recognition.

DSS and MP3 recording



The DSS format was developed for the use in digital voice recorders, achieving a high compression ratio with little loss of quality. The DSS format also allows you to store additional information in the file header, which facilitates the organization and the transcription of dictation files. The MP3 format is the common audio format for consumer audio storage, as well as a de facto standard encoding for the transfer and playback on digital audio players.

Wear-free slide switch



The quick-response and ergonomic slide switch is designed for single-handed operation of all recording and playback functions, allowing easy and quick file editing (insert, overwrite, append). It operates with a light sensor signal, making it wear-free and durable.

Robust and ergonomic design



The asymmetrical and ergonomic shape fits perfectly into your hand. Its slim and lightweight design maximizes comfort, even when working over longer periods of time. The stainless steel creates a robust and highly durable protective shell around the device.

Large color display



The large full-color display offers sharp images, making it easier to see everything at first glance. The clear user interface is optimized for easy, intuitive operation.

Extended battery life

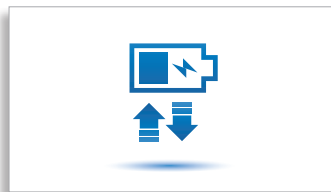

The high-capacity Li-ion battery can be easily charged through a standard micro USB jack. The integrated light sensor guarantees extended battery life, up to 50% longer than competition. The smart technology adjusts the brightness of the display, ensuring that your recorder will always be ready to work when you are.

Automatic download

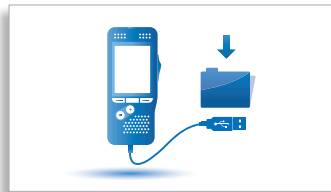

When plugged in, the Pocket Memo voice recorder automatically downloads your audio files directly onto the computer.

Classic mode



Many users still love their analog devices for their simplicity and user-friendliness. The optional classic mode gives the user the look and feel of working with an analog device while retaining the advantages of digital technology and keep focused on the essentials.

SpeechExec workflow software



The SpeechExec Dictate software organizes the workflow of dictation files and resulting documents between author and transcriptionist, and allows you to monitor the status of your work.

Ergonomic foot pedal

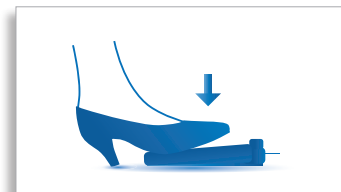

Slim, ergonomic design guarantees hands-free control of all playback functions with minimal physical strain.

Professional stereo headphones

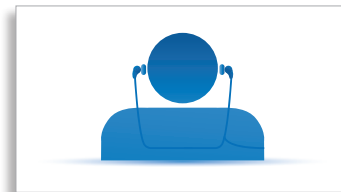

Lightweight under-the-chin-style stereo headphones designed to deliver excellent sound quality, with soft ear cushions for enhanced wearing comfort.

Priority settings



With the included priority setting option, urgent recordings can be processed first. This makes sure important recordings are not overseen and helps you and your transcriptionists manage your workloads better.

Specifications

Connectivity

- Headphones: 3.5 mm
- Microphone: 3.5 mm
- USB: micro USB 2.0
- Docking connector
- Memory card slot

Display

- Type: color TFT
- Diagonal screen size: 2.4 inches / 6.1 cm
- Resolution: 320 × 240 pixels

Storage media

- Exchangeable memory card
- Memory card types: SD/SDHC, up to 32 GB
- Mass storage class compliant
- Data transfer speed: 6.75 MB/s read speed, 5.0 MB/s write speed

Audio recording

- Recording format: DSS (Digital Speech Standard), MP3, PCM
- Built-in microphones: 2 omnidirectional microphones for stereo recording
- Recording modes: DSS QP (.ds2/mono), DSS SP (.dss/mono), MP3 (.mp3/stereo), PCM Voice (.wav/mono), PCM Stereo (.wav/stereo)
- Bit rate: 13.7 kbit/s (DSS SP), 28 kbit/s (DSS QP), 192 kbit/s (MP3), 353 kbit/s (PCM Voice), 705 kbit/s (PCM Stereo)
- Edit modes: insert (DSS), overwrite (DSS, MP3, PCM), append (DSS, MP3, PCM)
- Recording time (4 GB memory card): 700 hours (SP), 350 hours (QP), 50 hours (MP3), 27 hours (PCM Voice), 13 hours (PCM Stereo)
- Sample rate: 44.1 kHz (MP3), 22.05 kHz (PCM), 16 kHz (DSS QP), 12 kHz (DSS SP)

Sound

- Speaker type: built-in round, dynamic speaker
- Speaker diameter: 28 mm
- Acoustic frequency response: 300 – 7500 Hz
- Speaker output power: > 200 mW

Power

- Battery type: Philips rechargeable Li-ion battery ACC8100
- Battery capacity: 1000mAh
- Battery lifetime: up to 27 hours of recording (DSS mode)
- Standby time: more than 200 days
- Charging time (full charge): 3 hours

Dimensions

- Product dimensions (W × D × H): 53 × 123 × 15 mm / 2.1 × 4.8 × 0.6 inches
- Weight: 117 g/4.1 oz including battery and memory card

Foot pedal

- Connectivity: USB plug
- Product dimensions (W × H × D): 19.5 × 13 × 3.5 cm / 7.7 × 5.1 × 1.4 in.
- Weight: 0.660 kg/1.5 lb.

Stereo headphones

- Style: under chin
- Acoustic system: open
- Magnet type: neodymium
- Diaphragm: PET dome
- Voice coil: copper
- Sound quality: optimised for voice playback
- Impedance: 2 × 32 Ohm
- Maximum power input: 2 × 10 mW
- Sensitivity: 103 dB
- Speaker diameter: 14 mm/0.6 in.
- Cable connection: one-sided
- Cable length: 3.0 m/10 ft.
- Connector: 3.5 mm, right-angled, stereo
- Connector finish: Gold-plated
- Product dimensions (W × H × D): 16 × 15 × 1.8 cm / 6.3 × 5.9 × 0.7 in.
- Weight: 0.660 kg/1.5 lb.

System requirements (SpeechExec workflow software)

- Processor: Intel Pentium 4, 1.0 GHz or equivalent processor
- RAM memory: 1 GB (2 GB recommended)
- Hard disk space: 100 MB for SpeechExec software, 850 MB (32 bit)/2 GB (64 bit) for Microsoft .NET Framework (Windows)
- Operating system: Windows 8/7/Vista (32/64 bit), Mac OS X 10.9/10.8 (Mac functionality may be limited)
- Free USB port
- DVD-ROM drive
- Graphics card: DirectX-compliant graphics card with hardware acceleration recommended (Windows)

Green specifications

- Compliant to 2002/95/EC (RoHS)
- Lead-free soldered product

Operation conditions

- Temperature: 5° – 45° C/41° – 113° F
- Humidity: 10 % – 90 %, noncondensing

Package contents

- Pocket Memo digital voice recorder DPM7200
- Foot pedal LFH2330
- Stereo headphones LFH0334
- SDHC memory card
- SpeechExec Transcribe software
- SpeechExec Dictate software
- Rechargeable battery
- USB cable
- Pouch
- Quick start guide

Available accessories

- Philips rechargeable Li-ion battery ACC8100
- Philips SDHC memory card LFH9004
- Philips telephone pickup microphone LFH9162
- Philips meeting microphone LFH9172
- Philips docking station ACC8120





Issue date 2013-11-26
Version 1.2

© 2013 Speech Processing Solutions GmbH. All rights reserved.

Philips and the Philips' shield emblem are registered trademarks of Koninklijke Philips N.V. and are used by Speech Processing Solutions GmbH under license from Koninklijke Philips N.V. All trademarks are the property of their respective owners.

www.philips.com/dictation